



53rd ISCSC Conference
with our host and partner
the University of Lethbridge, Faculty of Health Sciences, Lethbridge, Canada
4401 University Drive, Lethbridge, Alberta T1K 3M4

Health, Healing and Civilizations

May 21 through 24, 2024

**CONFERENCE PROGRAM
SYLLABUS/AGENDA**

Territorial Acknowledgement

Oki, and welcome to the University of Lethbridge. Our University's Blackfoot name is Iniskim, meaning Sacred Buffalo Stone. The University is located in traditional Blackfoot Confederacy territory. We honour the Blackfoot people and their traditional ways of knowing in caring for this land, as well as all Aboriginal peoples who have helped shape and continue to strengthen our University community.

This 53rd ISCSC Conference with host and partner, University of Lethbridge, Faculty of Health Sciences, is an opportunity to reaffirm the vision that Civilizations Matter; to encourage new research; to elicit new thoughts and approaches; to renew discussion of what makes a “Civilization”; why some are resilient but some not, and to reach a wide range of disciplines.

CONFERENCE CHAIR: Professor Bonnie Lee Ph.D., University of Lethbridge
PROGRAM CHAIR, Greg Lewicki, Ph.D., Vice President of the ISCSC

INFORMATIONAL GUIDE FOR ATTENDEES	PAGE	3
IN CASE OF EMERGENCY DURING ATTENDANCE	PAGE	4
CAMPUS MAPS	PAGE	5 & 6
DAILY AGENDA	PAGE	7-12
PRE-CONFERENCE WORKSHOP	PAGE	13
FIELD TRIP	PAGE	14

A very special “Thank You” to Jon Doan Ph.D, Dean of the Faculty of Health Sciences
and to the Department of Conference Services.

INFORMATIONAL GUIDE FOR ATTENDEES

Pre-Conference Workshop: Science Commons Atrium. Tuesday May 21st, 1:00 pm to 3:30pm Details in Program/Agenda.

Campus or Indigenous Plants Tour: Tuesday May 21st, 3:45-4:45 p.m. Meet in Markin Hall Atrium.

Welcome Reception: Markin Hall Atrium M1048. Tuesday May 21st, 5:00 pm to 7:30 pm
Welcome Reception with complimentary hors d'oeuvres and cash bar.

Posters: Posters will be set up in the Markin Hall Atrium M1048 during the reception and throughout the conference to maximize interaction with authors and attendees.

Media Release: Photography and Video Release: Please be advised that photographs and/or short videos might be taken at the event for use on the ISCSC website, ISCSC social media, marketing materials, and other ISCSC related publications. By entering this event, you consent to the above referenced use of your image and likeness by the ISCSC.

Meeting Rooms: The primary presentation room will be the Markin Hall Large Amphitheater M1040 with the option of Small Amphitheatre M1090 if needed.

Meals: Breakfast and Dinner will be served in the Markin Hall Atrium M1048. Lunch is on your own on campus during the scheduled lunch break.
Conference reception and meals will be catered by a local catering company: Prime Catering*Italian Table.



To demonstrate our commitment towards Truth and Reconciliation, we acknowledge that our business is conducted on the traditional territories of the Blackfoot Confederacy who are made up of the Piikani Nation, Kainai Nation, and Siksika Nation and Amskapi Piikani Nation. We acknowledge that the Tsuut'ina Nation, Stoney Nakoda Nation, and Métis First Nation have also come to call these territories home. We acknowledge the people past, present, and future who make their home in these lands, and recognize these things in the spirit of Truth and Reconciliation.

Lodging: On campus lodging at the University of Lethbridge Lux Hotel.

Wi-Fi and parking are included. Use this link to register: <https://www.ulethbridge.ca/conference/hotel>

Three-night minimum stay. Direct questions to: cnf@uleth.ca or phone +1- 403-329-2244.

Off campus recommendation: Sandman Signature Lodge Hotel approx. 2.5 miles from campus with discounted rate for our group.

- Group Name: ISCSC
- Block 10:359900
- Block code:24051SCSC
- A valid credit card is required at the time of reservation to secure any guests rooms.

Guests can book directly with this link referring to the above information.

<https://reservations.sandmanhotels.com/113172?group10=4240386>

24-hour Central Reservation Office 1-800-726-3626.

Alternatively, you may call the 24-hour Central Reservations office at 1-800-726-3626 / 1-800-SANDMAN.

IN CASE OF EMERGENCY

On Campus: 24 Hour Assistance

Emergency first aid care is available 24 hours a day. On-campus Security Representatives are trained to assist with all medical emergencies and are available at all times.

For Serious or Life-Threatening Emergencies

- Call **9-1-1** for Fire, Ambulance and Police
- Remain calm and do not leave the injured/ill individual.
- Ensure the scene is safe - minimize further danger to the injured person or yourself.
- Do not move the person unless there is a high risk of further injury.
- Provide the dispatcher with the required information.
 - You will be asked if you require **police, ambulance or fire services**.
 - You will be asked to provide your name, phone number, location.
- THEN inform Security Services 403-329-2345 (**2345** from a in-house phone) of your 911 call immediately. They will be able to assist the ambulance/paramedics to reach you.

For Non-Emergency Injury or Illness

- Call a Security Representative at (403) 329-2345 or **2345** (on an in-house phone).
- Stay on the line and a Security Representative will speak with you shortly. Fully describe what is happening and the representative will come to your location.

Injuries occurring on campus require the completion of a report within 24 hours of the near-miss or injury.

MAP OF CONFERENCE GROUNDS

From Parking Lot N to Markin Hall
see **red line** for the short walk.

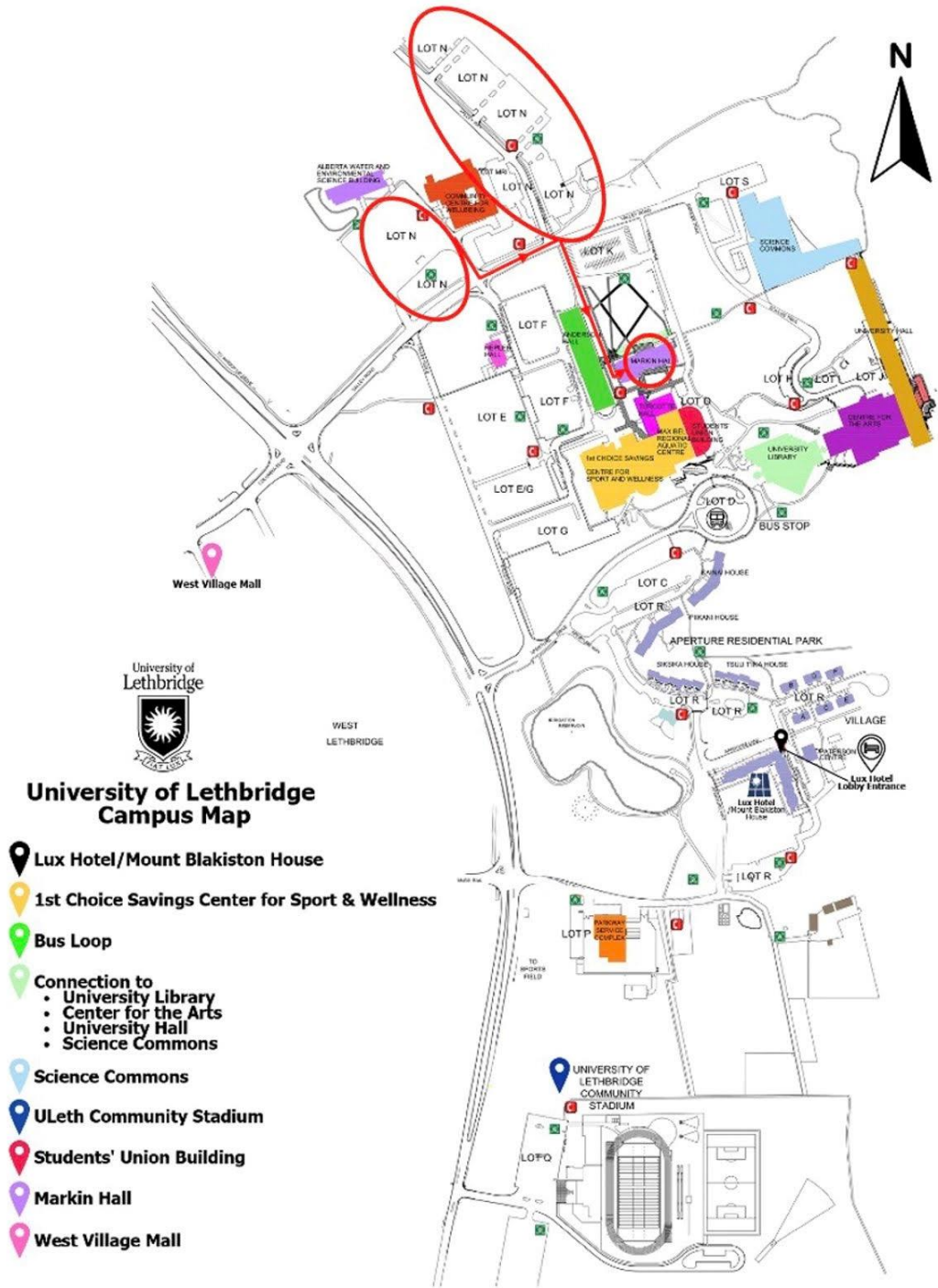

MAP OF MARKIN HALL

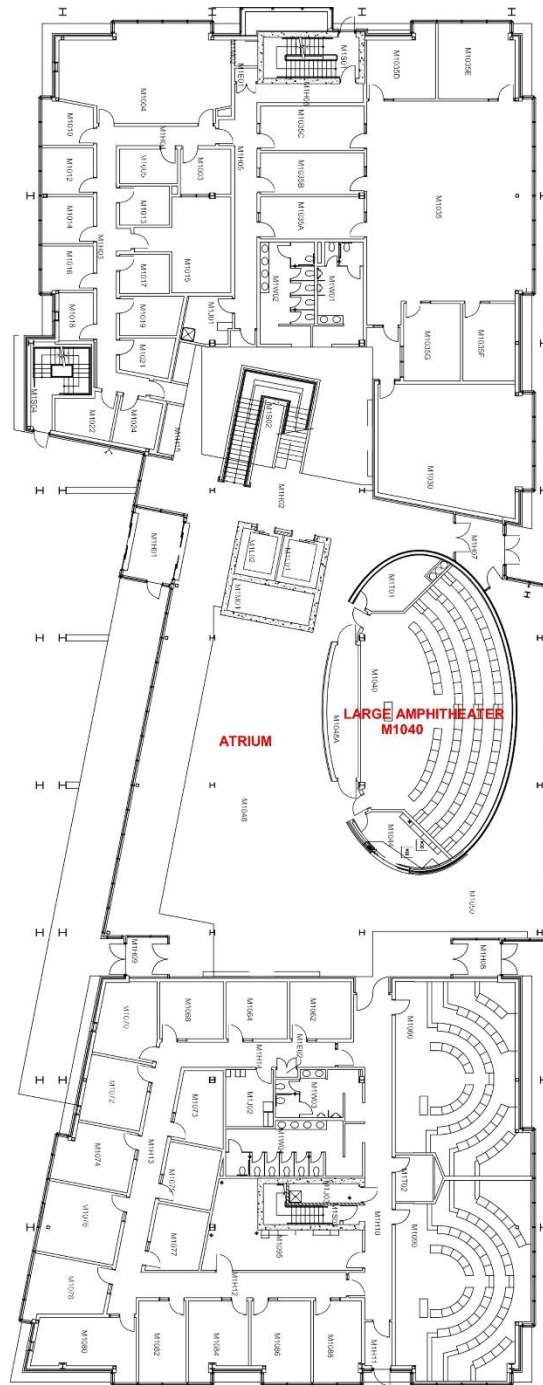

-DAILY AGENDA-

Tuesday May 21 through Friday May 24, 2024
 Program Schedule

53rd ISCSC Conference

Health, Healing and Civilizations

Presentations are scheduled as plenary sessions.

Markin Hall Large Auditorium M1040, Markin Hall Atrium, M1048
 other rooms available as needed M1040, M1090, M1004

Tuesday, May 21st

Tuesday May 21 st	Activity	Location and/or Speaker
1:00 to 3:30 pm	Pre-Conference Workshop <i>Collective Wellness-Indigenous Approaches to Healing</i>	Science Commons Atrium with Nevada Ouelette & Lacy Devine
3:45-4:45 pm	Campus or Indigenous Plants Tour (optional), rest, check in to lodging.	Meet in Markin Hall Atrium M1048
5:00 to 7:00 pm	Welcome Reception Hors d'oeuvres and first look at conference posters	Markin Hall Atrium, M1048
7:00 pm	Dinner on your own	

Posters: Posters will be set up in the Markin Hall Atrium M1048 during the reception and throughout the conference to maximize interaction with authors and attendees.

Wednesday, May 22nd

Wednesday, May 22	Activity	Location and/or Speaker
	Conference Check-in and Presentations	
7:00 to 8:30 am	Breakfast	Markin Hall Atrium M1048
8:15 to 8:45 am:	Check-in/Pick Up Conference Materials	Markin Hall Atrium M1048
9:00 to 9:20 am	<p style="text-align: center;">Welcome Day One</p> <p>Welcome comments, logistics, presentation protocols, facilitation of sessions, housekeeping</p>	<p>Markin Hall Large Amphitheater M1040 Bonnie Lee Greg Lewicki Jon Doan Lynn Rhodes</p>
9:20 to 12:10 am	Civilization Panel. Healthy Civilization in the Time of Troubles	Markin Hall Large Amphitheater M1040
Duration: 1.20h	<p>Jean-Baptiste Leca, What does it Take to Ratchet up? The Unresolved Comparative Psychology of Cumulative Culture</p> <p>Joseph Drew, Does the United States or Canada Show the More Successful Path Forward as a Multicultural Society within the Western Civilization?</p> <p>Sheila McManus, The Healing Power of Teaching World History</p> <p><i>Discussion (20 mins)</i></p>	<i>20 minutes per presentation</i>
10:40 to 10:50 pm	Short break	
10:50: to 12:10 pm (continued) Duration: 1:20	<p>Michael Andregg, Lessons from the US – Dakota War of 1862 Regarding the Welfare of Civilizations Facing Mass Migration</p> <p>Ken Baskin, Bacon’s Nightmare: The Dis-Integration of Western Culture</p> <p>John Grayzel, Rene Dubos, the Mirage of Health, and the Dynamics of Quantum Civilization</p> <p><i>Discussion (20 mins)</i></p>	<i>20 minutes per presentation</i>

12:10 to 1:10 pm	Lunch on campus	
1:10 to 3:00 pm Duration: 1.50h	Japan Panel. Harmony in Transition. Structural Reform and National Well-being in Japan Robert Bedeski , State Reform in Japan: Responding to Domestic and Global Challenges with ‘Structural Healing’ Aki Kinjo , How Companies Heal and Maintain Health: A Unique Function of Corporate Museums in Japan Hitomi Sano , 'Medical Inclusion' Health and Medical in the Global Digital Civilization Gideon Fujiwara , Healing through Verse: Themes of Health in the New Year Poetry Ceremony of Japan’s Imperial Court” <i>Discussion with Professor Yong-Chool Ha (30 mins)</i>	Markin Hall Large Amphitheater M1040 <i>20 minutes per presentation</i>
3:00 to 3:15 pm	Short break	Markin Atrium M1048
3:15 to 4:35 pm	Confucian Panel. Confucian Approach to Social Health and Democracy	Markin Hall Large Amphitheater M1040
Duration: 1:20h	John von Heyking , The Loneliness Health Crisis of Modern Democracy: How Well Can We Understand the Healing Power of Friendship? Bonnie Lee , Walking and Sitting Together: “Pui” as an Ethnographic Concept in Chinese Culture Patrick W. M. Chan , The Singapore Paradox: Capitalism and Socialism, Authoritarianism and Democracy <i>Discussion (20 mins)</i>	<i>20 minutes per presentation</i>
4:35 to 4:50 pm	Daily wrap up.	Markin Hall Large Amphitheater M1040 Lewicki, Lee, Rhodes
6:00 pm to	Dinner (cash bar service begins at 5:30 pm)	Markin Hall Atrium M1048

Posters: Posters will be set up in the Markin Hall Atrium M1048 during the reception and throughout the conference to maximize interaction with authors and attendees.

Thursday, May 23rd

Thursday, May 23	Activity	Location and/or Speaker
7:00 to 8:30 am	Breakfast	Markin Hall Atrium, M1048
9:00 am to 9:15	Program Chair and Conference Chair comments	Markin Hall Large Amphitheater M1040
9:15 to 10:35 am	Sorokin Panel. Pitirim Sorokin on Well-being and Healing	Markin Hall Large Amphitheater M1040
Duration: 1:20h	Svetlana Korneeva , Issue of Culture and Morality in P. Sorokin’s Crime and Punishment, Exploit and Reward Vlad Alalykin-Izvekov , Integralistic Paradigm in International Relations Theory: Theoretical Framework and Practical Applications Emiliana Mangone [video], Sociology of Crisis through Pitirim A. Sorokin’s Scholarly Legacy. Current problems, resilience and community <i>Discussion (20 mins)</i>	<i>20 minutes per presentation</i>
10:35 to 10:50 am	Short break	Markin Atrium, M1048
10:50 to 12:10 am	AI Panel. The Impact of Artificial Intelligence on Human Psychology	Markin Hall Large Amphitheater M1040
Duration: 1:20h	Greg Lewicki , Artificial Intelligence and Authentic Intimacy. Possible Psychological Consequences of Intimate Human Bonding with Large Language Models Brady Cahoon , Relationships in the Age of Artificial Intelligence Bibi Pelić , From Gregorian Chants to Algorithmic Harmonies: The Evolution of Music in Mental Health <i>Discussion (20 mins)</i>	<i>20 minutes per presentation</i>
12:10-1:10 pm	Lunch on campus	Various locations
1:10 to 1:40 pm	ISCSC Board/Membership meeting (all board members requested and members/attendees invited)	Markin Hall Large Amphitheater M1040
1:45 to 5:00 pm	Health Practices Panel. Examining Social Isolation, Religion and Industrialized Indulgences	Markin Hall Large Amphitheater M1040

Duration: 1:20h	<p>Lynn Rhodes, Having Ancient Roots, “Wellness” is a Modern Definition</p> <p>Hisanori Kato, The Viability of Religious and Cultural Purity: the Relationship between Local Civilisation and Islam in Indonesia</p> <p>Brenda Leung, Achieving Health in the Age of Industrialized Indulgences: Civilization and Food <i>Discussion (20 mins)</i></p>	<i>20 minutes per presentation</i>
3:05 to 3:20	Short break	
3:20 to 5:00 pm (continued) Duration: 1:40h	<p>Mandy DeCecco-Kolebaba, Meeting Clients where They are At: Transforming Conventional Counselling Norms to Maximize Connection in Counselling Indigenous Clients in Active Addiction</p> <p>Geoffrey Maina, Perspectives of Immigrants on Community Substance Use Issues in Regina, Canada: Implications for policies and practices.</p> <p>Gerlinde Metz, Impact of Social Isolation on Lifetime Health and Future Generations</p> <p>Mark W. Slomp and Shaylona Raju-Bunnage, Promoting Student Social Health on Post-secondary Campuses <i>Discussion (20 mins)</i></p>	<i>20 minutes per presentation</i>
5:00 to 5:15 pm	Daily wrap-up and recognitions	Markin Hall Large Amphitheater M1040
6:00 to 8 pm	Closing Dinner (cash bar service begins at 5:30 pm)	Markin Atrium M1048

Posters: Posters will be set up in the Markin Hall Atrium M1048 during the reception and throughout the conference to maximize interaction with authors and attendees.

Friday, May 24th

Friday, May 24	Activity	Location and/or Speaker
7:00 to 8:15 am	Breakfast	Markin Atrium, M1048
8:30 am to 5:45 pm	Board Bus for Field Trip Lunch in historic Waterton Return to campus approx. 6:00 pm	Head Smashed-In Buffalo Jump and Waterton Lakes National Park. Both are UNESCO World Heritage Sites
Evening	Dinner on your own	

Saturday, May 25th

Saturday, May 25	Activity	Location and/or Speaker
	Attendees depart	

PRE-CONFERENCE WORKSHOP

Collective Wellness- Indigenous Approaches to Healing with Nevada Ouellette.



The experiential workshop integrates Indigenous land-based learning, embodying the Cree concept "Sakihitowin" or "love," symbolizing the opening of the heart. Grounded in ceremony, it blends traditional teachings, land-based wellness approaches, and Indigenous psychotherapy. Participants will gain tools for their wellness journey, a profound connection to their own medicine, a deeper understanding of interconnectedness, and an experiential grasp of Indigenous epistemologies. Anticipated to leave a lasting impact, this experience contributes to authentic reconciliation and a shared, brighter future across disciplines.

By anchoring the Health, Healing, and Civilization Conference in Indigenous ways of being, this pre-conference workshop sets a tone of love, connection, and unity. Open to attendees from diverse backgrounds, disciplines, and nations worldwide, it creates a welcoming and secure space.

Nevada Lynn Ouellette BHSc, MEd Kihcihtwaw Asinewiskwew (Holy Rock Woman) is Ojibway/Cree-Métis, Russian and Polish and a member of the Métis Nation of Alberta (MNA). She describes her way of life resembling that of her ancestors—a core foundation in traditional ways of being while drawing upon the strengths and adapting to modern day life. She holds a master's degree in counselling psychology and is a trained Indigenous Focusing Oriented Therapy (IFOT) therapist. Her academic accomplishments include a publication in *Canadian Journal of Counselling Psychology*, "Reconciling relations: Shifting counselling psychology to address truth and reconciliation" and a book chapter in *Diversity and Addictions Counselling* textbook "Moving towards reconciliation: Indigenous approaches to addictions counselling and psychotherapy". This past year Nevada was a sessional Instructor at the University of Lethbridge where she designed and delivered the "Indigenous Perspectives on Counselling and Wellness" through an Indigenous lens. Her work focuses on Indigenous approaches to wellness, education and counselling/trauma and development and facilitation of Indigenous Land-Based trauma healing programs. She has a passion for working with people of all nations to bridge the gap that exist between Indigenous and non-Indigenous communities. She believes that when we gather in the name of "Collective Wellness" we create alliances for a brighter future together. Nevada is the founder of Collective Wellness Pow Wow and through her business she provides consultation services, Indigenous therapeutic services and offers variety of Indigenous Land-Based educational, wellness, professional development workshops.

FIELD TRIP

After breakfast on Friday May 24th, we will travel by bus to Head-Smashed-In Buffalo Jump and Waterton Lakes National Park. Both are UNESCO World Heritage Sites, relevant for their cultural and natural significance, as well as their connection to the history and identity of the Indigenous peoples of the region. Archaeologists from University of Lethbridge will be on site at Head-Smashed-In Buffalo Jump to share their current project work. In Waterton Lakes National Park, there you will have time pick your lunch spot in addition to seeing the wonders of this historic place. Our bus is scheduled to return to campus by approximately 6:00 pm.

Head-Smashed-In Buffalo Jump Interpretive Centre is a UNESCO-designated World Heritage Site that preserves and interprets over 6,000 years of Plains Buffalo culture. Through vast landscapes, exhibits, and diverse programming, learn about the cultural significance of this cliff to the Plains People. More information: <https://headsmashedin.ca/>

Waterton Lakes National Park Waterton: Rocky Mountains and crystal clear lakes, acres of wildflowers, miles of trails and centuries of fascinating history. Rugged natural beauty you won't see anywhere else. In addition to the park itself, explore the village boutiques, enjoy dining that celebrates fresh local ingredients.

<https://parks.canada.ca/pn-np/ab/waterton>

Places to dine in Waterton Lakes: <https://mywaterton.ca/eat>



International Society for the Comparative Study of Civilizations

Our Mission and Goal

***Mission:** To provide means of cooperation among all persons interested in the advancement of the comparative study of civilizations.*

***Vision:** Civilizations matter.*

***Goal:** To achieve scholar recognition as the primary source of knowledge and wisdom on the comparative study of civilization.*

***Strategy:** Organizing annual international conferences with scholar leaders of the comparative study of civilization and publishing*

Comparative Civilization Review, Conference Proceedings & Civilization Book Series.